

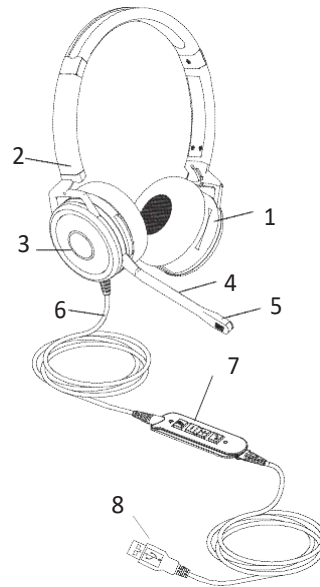

**GU3005**  
**Advanced USB Corded Headset**  
Quick User Guide



**Headset Components**

- 1 Receiver
- 2 Adjustable headband
- 3 Busy light indicator
- 4 Flexible microphone boom
- 5 Noise-canceling microphone
- 6 Headset cable
- 7 Controller
- 8 USB

**Buttons and Lights**

- 1 Mute microphone indicator
- 2 Mute microphone
- 3 Volume control
- 4 Answer/End button
- 5 Off-Hook indicator

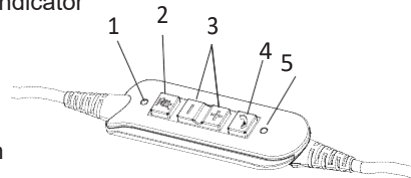

**Using Your Headset**

1. Connect your GU3005 Headset to a free USB port on your PC.
2. Make sure that the headset has been selected as the standard audio device in the system control audio settings.
3. Check whether you need to adjust these settings to use a headset.

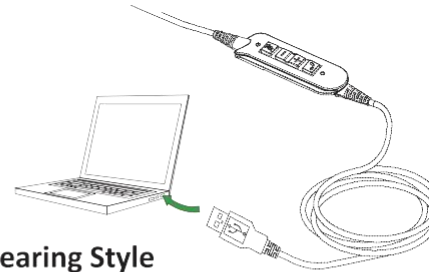

**Left or Right Wearing Style**

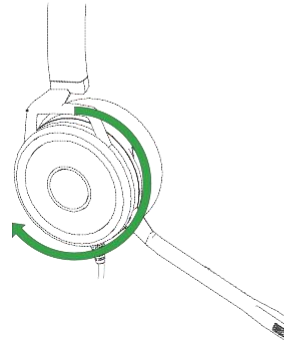

The GU3005 can be worn on the left or right by flipping the microphone to the other side (235° limit).

To change ears, rotate the microphone boom over the headband to accommodate the left or right ear.



**Adjust the Headband**

Place the headset receiver to your ears. Adjust the headband until it is comfortable, ideally ensuring that there is virtually no pressure felt on the ears.

**Position the Microphone**

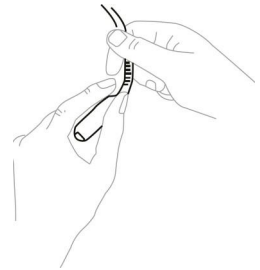
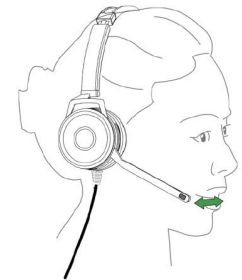

To avoid low or distorted sound, and to provide clear and crisp telephone calls, the microphone should be positioned within 0.5 inches of your mouth. The microphone boom arm will move in a variety of directions to ensure the best fit.

## How to Use the Headset Controller

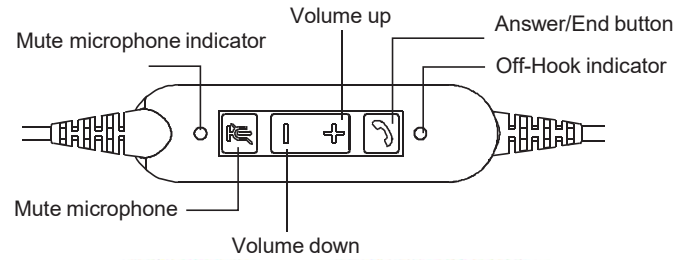

	FUNCTION	ACTION / STATUS
	Answer/End call	Tap the Answer/End button
	Adjust volume	Tap the Volume up or Volume down button
	Mute the microphone	Tap the mute microphone button
	Call light on/off	Tap the Answer/End button, Blue light on
	Busy light indicator	When available, Green light on. Tap the Answer/End button, Red light on.
	Mute on/off	When mute, Red light on

## Turn on/off microphone AGC

For better user experience, you may enable/disable AGC (Audio Gain Control), follow below instructions for Windows:

1. Access "Sound Control Panel".
2. Go to "Recording" tab and double click on "GUV3005".
3. Access to "Custom" tab and check/uncheck AGC, to enable/disable AGC.

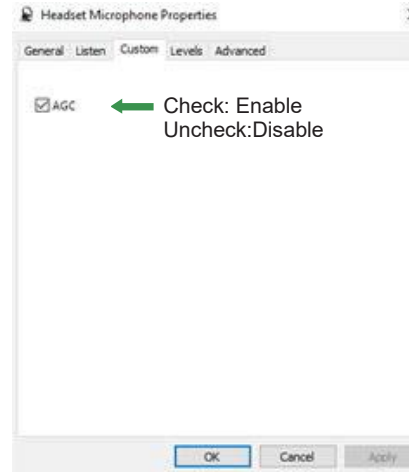

## U.S. FCC Part 15 Regulatory Information

This device complies with part 15 of the FCC Rules. Operation is subject to the following two conditions: (1) this device may not cause harmful interference, and (2) this device must accept any interference received, including interference that may cause undesired operation.

Any Changes or modifications not expressly approved by the party responsible for compliance could void the user's authority to operate the equipment.

Note: This equipment has been tested and found to comply with the limits for a Class B digital device, pursuant to part 15 of the FCC Rules. These limits are designed to provide reasonable protection against harmful interference in a residential installation. This equipment generates, uses and can radiate radio frequency energy and, if not installed and used in accordance with the instructions, may cause harmful interference to radio communications. However, there is no guarantee that interference will not occur in a particular installation. If this equipment does cause harmful interference to radio or television reception, which can be determined by turning the equipment off and on, the user is encouraged to try to correct the interference by one or more of the following measures:

- Reorient or relocate the receiving antenna.
- Increase the separation between the equipment and receiver.
- Connect the equipment into an outlet on a circuit different from that to which the receiver is connected.
- Consult the dealer or an experienced radio/TV technician for help.

## Precautions

1. Always store the headset with the power off and safely protected.
2. Avoid storage at extreme temperatures (above 25° C/77°F or below -20°C/-4°F). This may adversely affect the headset.

Grandstream Networks, Inc.  
126 Brookline Ave, 3rd Floor  
Boston, MA 02215 USA  
Voice: (617) 566-9300  
Fax: (617) 249-1987  
www.grandstream.com

FCC ID: YZZGUV3005



For Certification, Warranty and RMA information, please visit

www.grandstream.com



**GU3005**  
高清 USB 耳机  
快速安装手册

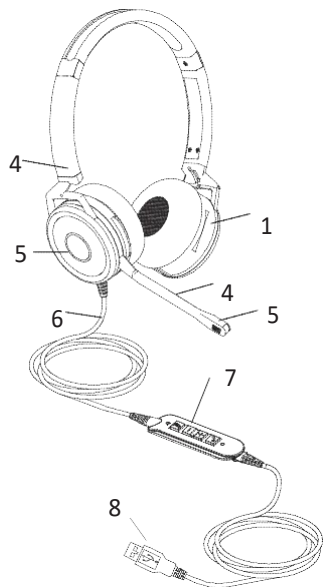

**耳机组件**

- 1 接收器
- 2 可调节头带
- 3 忙灯指示灯
- 4 可调麦克风臂架
- 5 降噪麦克风
- 6 耳机线
- 7 控制器
- 8 USB

**按钮和指示灯**

- 6
- 7
- 8
- 9 /
- 10

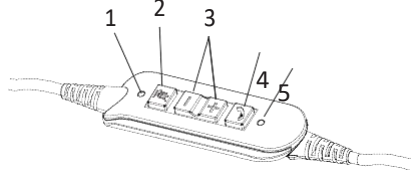

**使用您的耳机**

- 1. GU3005
- 2.
- 3.

USB

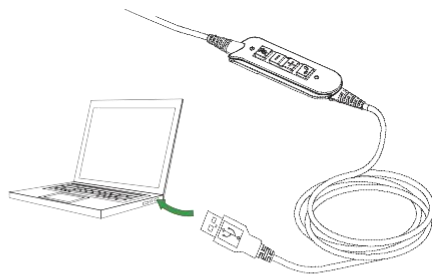

**左右佩戴类型**

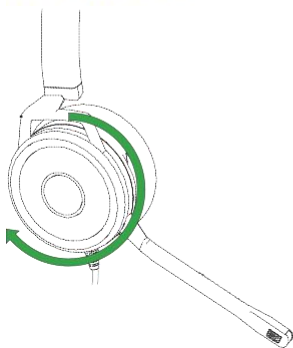

GU3005

( 235°)

**调整头带**



**定位麦克风**



0.5

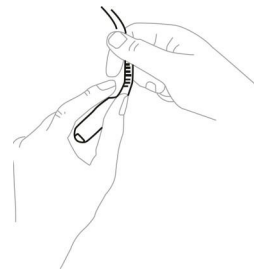

## 如何使用耳机控制器

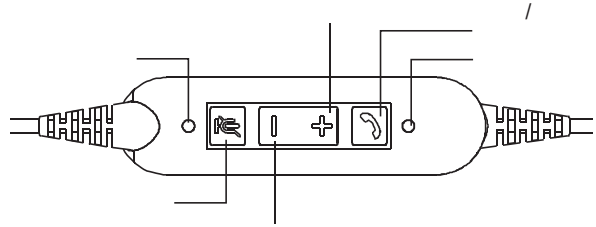

功能	动作/状态
	/
	/
	/
	/
	/

## 开启/关闭麦克风 AGC

/ AGC  
Windows

1. 进入声音控制面板
2. 进入“录制”标签，双击“GUV3005”
3. 进入“自定义”标签，勾选
4. AGC 来启用音频增益功能

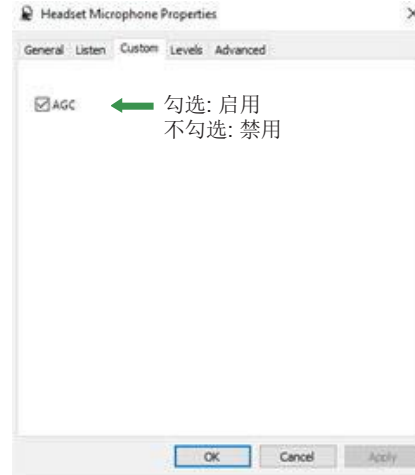

## 美国 FCC 第 15 部分法规信息

本设备符合 FCC 规则的第 15 部分，操作必须符合以下两个条件：(1)此设备不会造成有害干扰。(2)本设备必须能接受任何干扰，包括可能导致意外操作的干扰。

未经履约方的明确许可而进行的任何更改或修改可能会导致用户失去设备操作权限。

注意：  
B

FCC 15

- 调整接收天线的方向和位置。
- 增加设备和接收器之间的距离。
- 将设备连接到与接收器不同电路的插座上。
- 向经销商或有经验的通信技术人员咨询以获得帮助。

## 预防措施

1. 始终在关闭电源并妥善保护耳机的情况下存放耳机。
2. 避免在极端温度（25°C / 77°F 或低于 -20°C / -4°F）下存放。这可能会对耳机产生不利影响。

Grandstream Networks, Inc.  
126 Brookline Ave, 3rd Floor  
Boston, MA 02215 USA  
电话: (617) 566-9300  
传真: (617) 249-1987  
www.grandstream.com

FCC ID: YZZGUV3005



相关认证，保修和 RMA 的信息，请访问

www.grandstream.com